

SHIPCO PUMPS

MANUFACTURED BY

SHIPPENSBURG PUMP COMPANY INC.

P.O. Box 279 Shippenburg, Pa. 17257

PHONE 717 532-7321 / FAX 717 532-7704

WWW.SHIPCO.PUMPS.COM

SHIPCO® IS A REGISTERED TRADEMARK OF SHIPPENSBURG PUMP CO., INC.

**129 Model P Horiz End Suction
JM Frame's 143, 145, 182, & 184
Above 130 GPM (3500 RPM)**

DRAWN BY M. LINEAWEAVER DATE 9/04 REVISION .5

PARTS LIST # PL-82927

QUEB PART # 129PHJM+(35)S

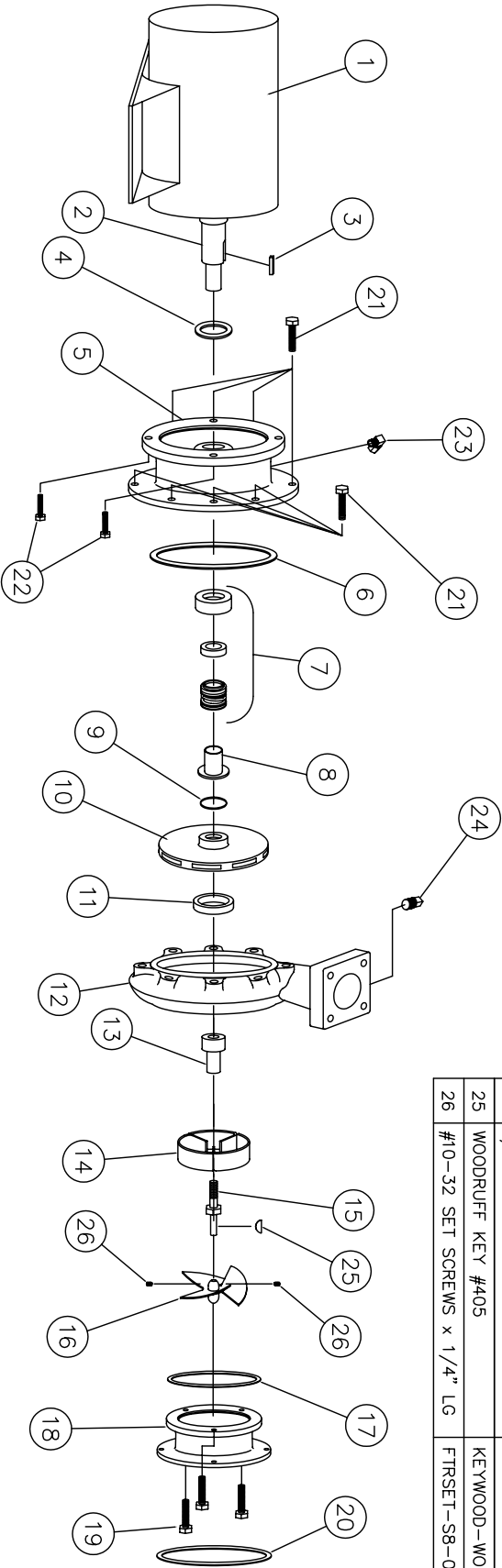

PARTS LIST

NO.	DESCRIPTION	PART NO.	QTY.
1	MOTOR	JM FRAME	1
2	MOTOR SHAFT		1
3	KEY (MOTOR TO IMPELLER)	KEYBAR-S8-019-OVR	1
4	WATER SLINGER	SLINGER-SDWS9998	1
5	PUMP HEAD	HEAD-SDPH00063	1
6	HEAD GASKET (O-RING)	ORING-SDP000088	1
7	MECHANICAL SEAL 1 1/8"	MCHSEAL-SDPS00155	1
8	SHAFT SLEEVE	SHTSLVE-SDPC00218	1
9	"O" RING (SHAFT SLEEVE)	ORING-SDP000051	1
10	IMPELLER	IMP-SDP100065	1
11	WEARING RING	WRGRING-SDPWR00131	1
12	PUMP CASE	CASE-SDPC00061-B	1
13	PROPELLER STEM	PROPSTM-SDPS00678	1
14	STRAIGHTENING VANES	STRVANE-SDPS00139	1
15	PROPELLER STEM BOLT	PROPSTM-SDPS00679	1
16	PROPELLER	PROPELR-SDPP00660	1
17	SUCTION HOUSING GASKET	GASKET-SDPG03836	1
18	SUCTION HOUSING	SUCHSG-SDPF00025-A	1
19	CAPSCREWS (suction housing to case) 3/8 x 1 1/4"	FTRCP-5HZ-0038C-0125-2	3
20	SUCTION GASKET	FLG-ASA-SP15-GKT-0400	1
21	CAPSCREWS (HEAD TO CASE)	FTRCP-5HZ-0038C-0100-2	8
22	CAPSCREWS (MOTOR TO HEAD) 3/8 x 3/4"	FTRCP-5HZ-0038C-0075-S	4
23	1/4" 90° COMPRESSION FITTING	CMPFTG-R-MELL-038-025	1
24	1/4" PIPE PLUG	PF-PLUGSQ-SLD-B-0025	1
25	WOODRUFF KEY #405	KEYWOOD-WOODRUFF-#405	1
26	#10-32 SET SCREWS x 1/4" LG	FTRSET-S8-0010F-0025	2