

SHIPCO PUMPS

MANUFACTURED BY

SHIPPENSBURG PUMP COMPANY INC.

P.O. Box 279 Shippensburg, Pa. 17257

PHONE 717 532-7321 / FAX 717 532-7704

WWW.SHIPCO-PUMPS.COM

SHIPCO® IS A REGISTERED TRADEMARK OF SHIPPENSBURG PUMP CO., INC.

113 Model D Horiz End Suction JM Frame's 143, 145, 182, & 184

DRAWN BY J.BROOKENS DATE 9/04 REVISION 4

PARTS LIST # PL-81308
CUBE PART # 113DHHJM

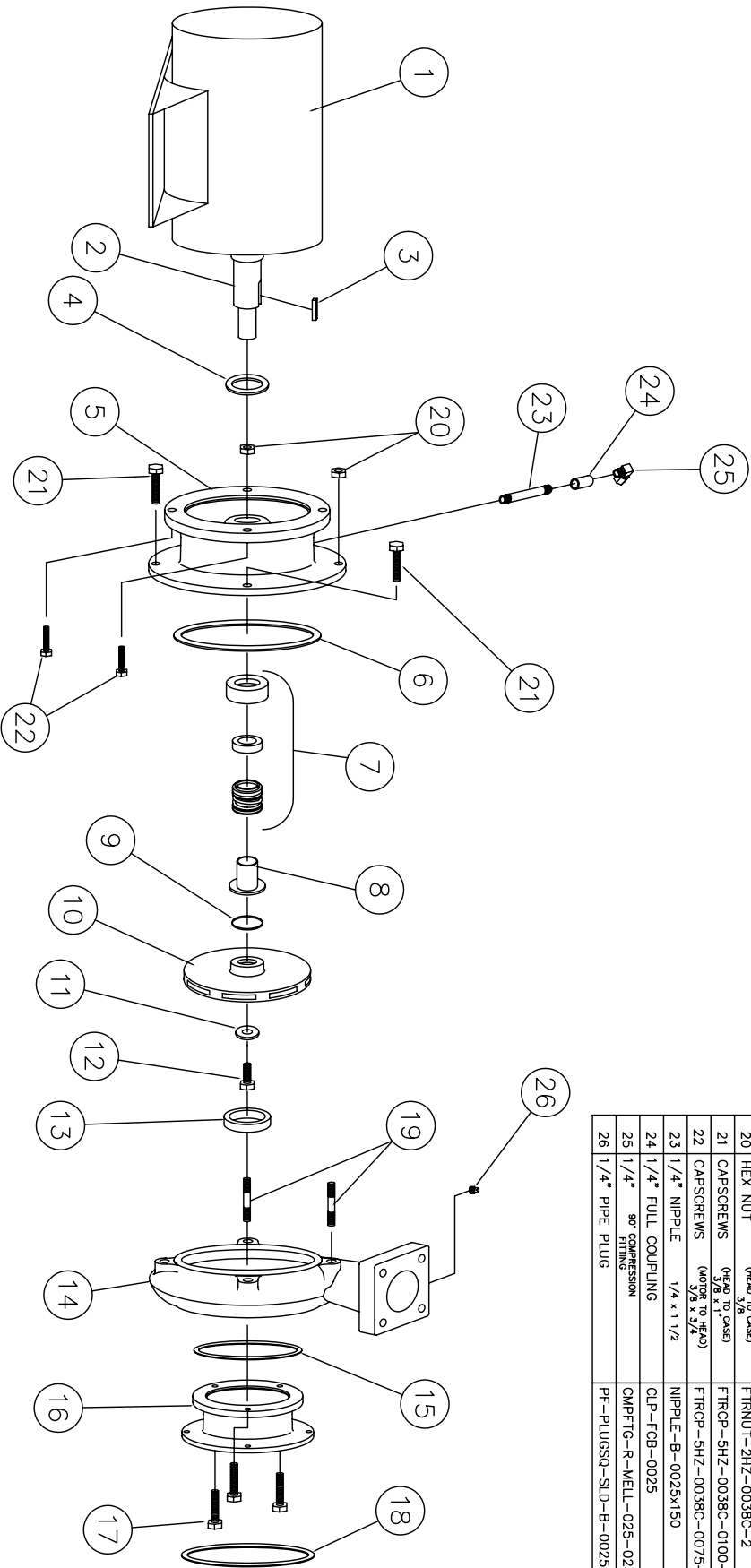

PARTS LIST

NO.	DESCRIPTION	PART NO.	QTY.
1	MOTOR	JM FRAME	1
2	MOTOR SHAFT		1
3	KEY (MOTOR TO IMPELLER)	KEYBAR-S8-019-OVR	1
4	WATER SLINGER	SLINGER-SDWS99998	1
5	PUMP HEAD	HEAD-SDPH00133	1
6	HEAD GASKET	GASKET-SDPG03826	1
7	MECHANICAL SEAL 1 1/8"	MCHSEAL-SDPS00155	1
8	SHAFT SLEEVE	SHTSLVE-SDPC00218	1
9	"O" RING (SHAFT SLEEVE)	ORING-SDP000051	1
10	IMPELLER	IMP-SDPI00127-A	1
11	IMPELLER WASHER	IMPWHR-SDPRW00237	1
12	CAPSCREW 3/8 x 1"	FTRCP-HS8-0038C-0100-2	1
13	WEARING RING	WRGRING-SDPWR0158	1
14	PUMP CASE	CASE-SDPC00126	1
15	SUCTION HOUSING GASKET	GASKET-SDPG03829	1
16	SUCTION HOUSING	SUCHSG-SDPF00050-B	1
17	CAPSCREWS (Suction Housing to Case)	FTRCP-SHZ-0038C-0125-2	3
18	SUCTION GASKET	FLG-ASA-SP15-GKT-0300	1
19	STUD	FTRSTUD-2P-0038C-0138-2	2
20	HEX NUT	FTRNUT-2HZ-0038C-2	2
21	CAPSCREWS (Head to Case)	FTRCP-SHZ-0038C-0100-2	2
22	CAPSCREWS (MOTOR TO HEAD)	FTRCP-SHZ-0038C-0075-2	4
23	1/4" NIPPLE	NIPPLE-B-0025x150	1
24	1/4" FULL COUPLING	CLP-FGB-0025	1
25	1/4" 90° FITTING	CMPTFG-R-MELL-025-025	1
26	1/4" PIPE PLUG	PF-PLUGSQ-SLD-B-0025	1