

# SHIPCO PUMPS

MANUFACTURED BY

SHIPPENSBURG PUMP COMPANY INC.

P.O. Box 279 Shippenburg, Pa. 17257

PHONE 717 532-7321 / FAX 717 532-7704

WWW.SHIPCO-PUMPS.COM

SHIPCO® IS A REGISTERED TRADEMARK OF SHIPPENSBURG PUMP CO., INC.

114 Model D Horiz End Suction  
JM Frame's 143, 145, 182, & 184  
Above 130 GPM

DRAWN BY J.BROOKENS DATE 9/04 REVISION .4

PARTS LIST # PL-81411

QUBE PART # 114DHJM+S

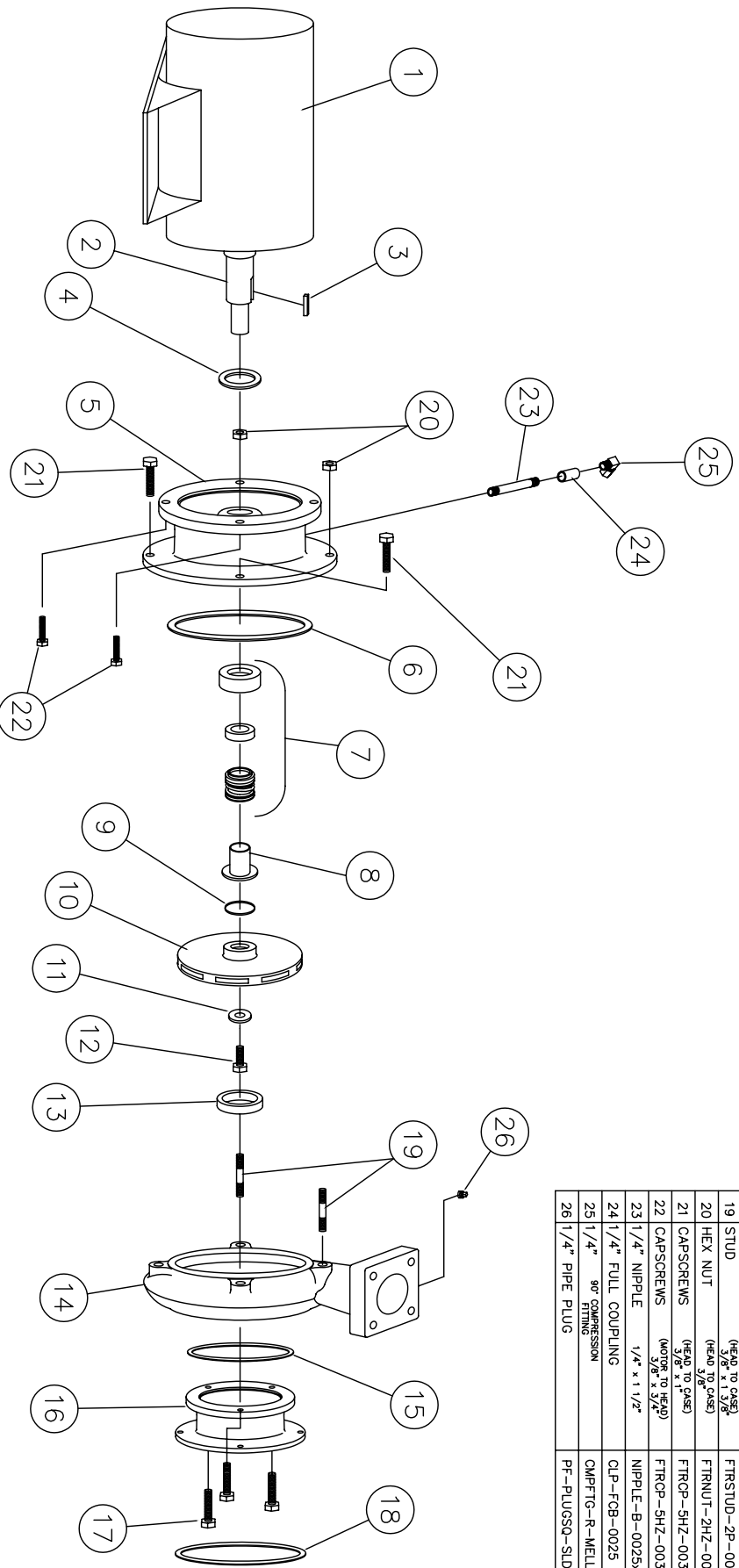

PARTS LIST			
NO.	DESCRIPTION	PART NO.	QTY.
1	MOTOR	JM FRAME	1
2	MOTOR SHAFT	KEYBAR-S8-019-OVR	1
3	KEY (MOTOR TO IMPELLER)	SLINGER-SDWS99998	1
4	WATER SLINGER	HEAD-SDPH00133	1
5	PUMP HEAD	GASKET-SDPG03826	1
6	HEAD GASKET	MCHSEAL-SDPS00155	1
7	MECHANICAL SEAL 1 1/8"	SHTSLVE-SDPC00218	1
8	SHAFT SLEEVE	ORING-SDPO 00051	1
9	"O" RING (SHAFT SLEEVE)	IMP-SDP100147-A	1
10	IMPELLER	IMPWHR-SDPRW00237	1
11	IMPELLER WASHER	FTRCP-HS8-0038C-0100-2	1
12	CAPSCREW 3/8 x 1"	WRGRING-SDPWR00068	1
13	WEARING RING	CASE-SDPC00148-B	1
14	PUMP CASE	GASKET-SDPG03836	1
15	SUCTION HOUSING GASKET	SUCHSG-SDPF00025	1
16	SUCTION HOUSING	FTRCP-5HZ-0038C-0125-2	3
17	CAPSCREWS (SUCTION HOUSING TO CASE)	GASKET-SDPG03857	1
18	SUCTION GASKET	FTRSTUD-2P-0038C-0138-2	2
19	STUD	FTRNUT-2HZ-0038C-2	2
20	HEX NUT	FTRCP-5HZ-0038C-0100-2	2
21	CAPSCREWS	FTRCP-5HZ-0038C-0075-2	4
22	CAPSCREWS (MOTOR TO HEAD)	NIPPLE-B-0025x150	1
23	1/4" NIPPLE 1/4 x 1 1/2"	CLP-FCB-0025	1
24	1/4" FULL COUPLING	CMPTG-R-MELL-025-025	1
25	1/4" 90° COMPRESSION FITTING	PF-PLUSQ-SLD-B-0025	1
26	1/4" PIPE PLUG		1