

SHIPCO® SPUMPS

MANUFACTURED BY

SHIPPENSBURG PUMP COMPANY INC.

P.O. Box 279 Shippenburg, Pa. 17257

PHONE 717 532-7321 / FAX 717 532-7704

WWW.SHIPCO-PUMPS.COM

SHIPCO® IS A REGISTERED TRADEMARK OF SHIPPENSBURG PUMP CO., INC.

416 AWF-B Vertical & Horizontal 182, 184, 213 & 215 TC Frame Three Phase Flexible Coupled

DRAWN BY S.A.D. DATE 6/07 REVISION .4

PARTS LIST # PL-81633

AWF16B-4STG-S

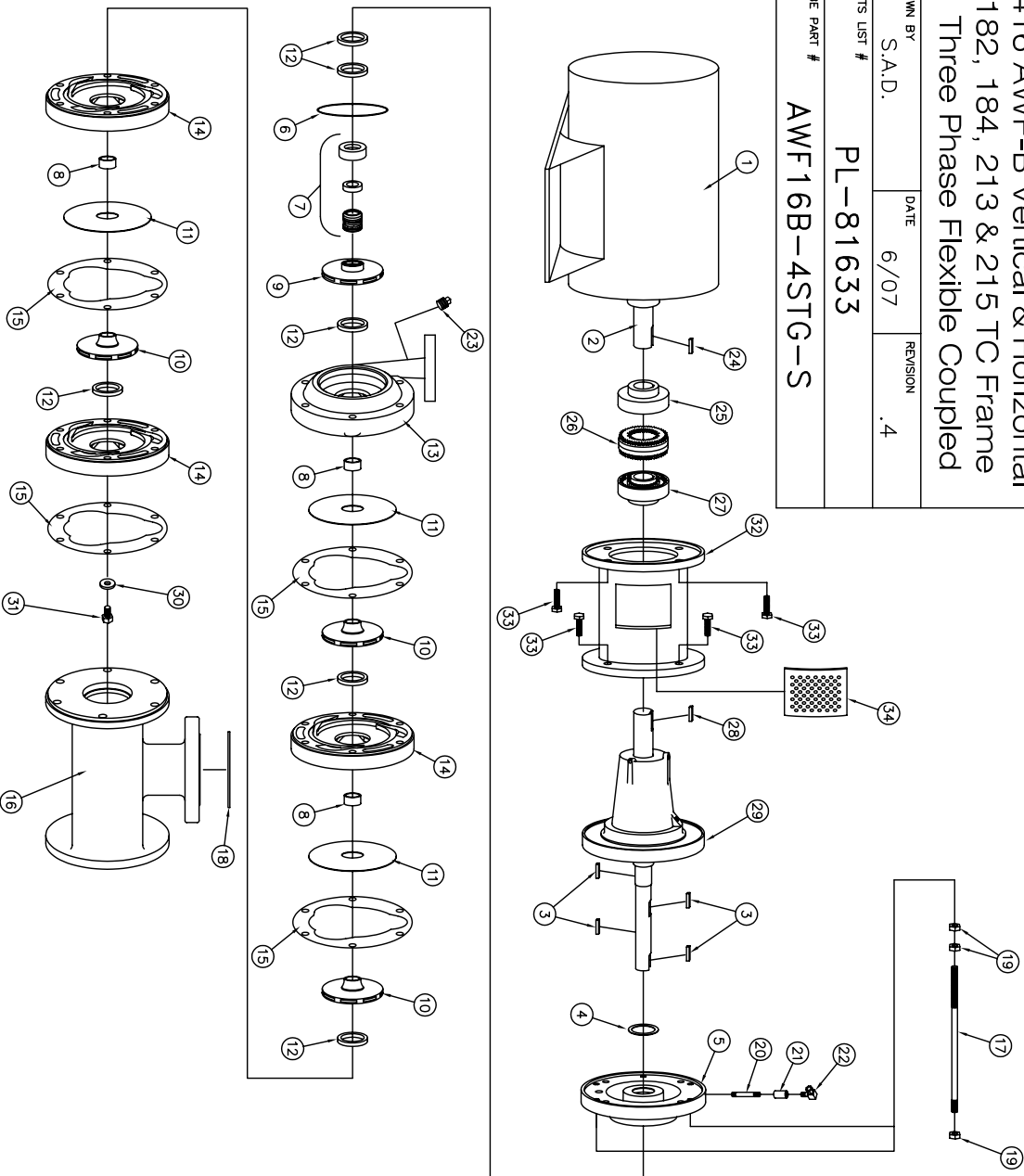

PARTS LIST

| NO. | DESCRIPTION | PART NO. | QTY. |
|-----|------------------------------------|-----------------------------|------|
| 1 | MOTOR / BEARING HOUSING | TC FRAME | 1 |
| 2 | MOTOR SHAFT | KEYBAR-S8-013-OVR | 1 |
| 3 | KEY (IMPELLER) | SLINGER-SDWS9996 | 4 |
| 4 | WATER SLINGER | HEAD-SDPH00581 | 1 |
| 5 | PUMP HEAD | ORING-SDP00674 | 1 |
| 6 | HEAD GASKET (O-RING) | MCHSEAL-SDPS00155-SV | 1 |
| 7 | MECHANICAL SEAL 1 1/8" | SPACER-SDP500579 | 3 |
| 8 | SPACER SLEEVE | IMP-SDP00042-1-4-7/8 | 1 |
| 9 | IMPELLER (4th STAGE) | IMP-SDP00042-1-A-4-7/8 | 1 |
| 10 | IMPELLER (1st thru 3rd STAGE) | DIVPLT-SDPP00885 | 3 |
| 11 | DIVIDER PLATE | WRGRING-SDPWR0032 | 6 |
| 12 | WEARING RING | CASE-SDPC00577 | 1 |
| 13 | PUMP VOLUTE CASE | PASSAGE-SDPP00576 | 3 |
| 14 | PASSAGE | GASKET-SDPG03886 | 4 |
| 15 | SUCTION HOUSING GASKET | SUCHSG-SDPH00747 | 1 |
| 16 | SUCTION HOUSING (HORIZONTAL MOUNT) | SUCHSG-SDPH00747-A | 1 |
| 17 | SUCTION HOUSING (VERTICAL MOUNT) | CLAMPINGBOLT-SDPB00595-B | 6 |
| 18 | CLAMPING BOLT | FLG-ASA-SP15-GKT-0300 | 1 |
| 19 | SUCTION GASKET | FTRNUT-9HZ-0050C-2 | 18 |
| 20 | HEX NUT (STAGE RETAINING NUT) | NIPPLE-B-0025x250 | 1 |
| 21 | 1/4" NIPPLE 1/4 x 1/2 | CLP-FCB-0025 | 1 |
| 22 | 1/4" FULL COUPLING | CPMFTG-R-MELL-038-025 | 1 |
| 23 | 1/4" 90° COMPRESSION FITTING | PF-PLUGSQ-SLD-B-0025 | 1 |
| 24 | KEY (MOTOR SIDE) | PER MOTOR ORDERED | 1 |
| 25 | WOODS COUPLING (MOTOR) | PER MOTOR ORDERED | 1 |
| 26 | SURE-FLEX SLEEVE | PER MOTOR ORDERED | 1 |
| 27 | WOODS COUPLING (PUMP SIDE) | PER MOTOR ORDERED | 1 |
| 28 | KEY (PUMP SIDE) | KEYBAR-S8-025-OVR | 1 |
| 29 | BEARING ASSEMBLY | BRGHSG-SDPBH00686 | 1 |
| 30 | IMPELLER WASHER | IMPWR-SDPRW00671 | 1 |
| 31 | IMPELLER BOLT | - | 1 |
| 32 | ADAPTOR ASSEMBLY | BRGHSG-SDPH00587 | 1 |
| 33 | MOUNTING BOLT | - | 8 |
| 34 | COUPLING GUARD SCREEN | BRGHSG-GUARDSCREEN-S3333331 | 1 |