

SHIPCO® SPUMPS

MANUFACTURED BY

SHIPPENSBURG PUMP COMPANY INC.

P. O. Box 279 Shippensburg, Pa. 17257

PHONE 717 532-7321 / FAX 717 532-7704

WWW.SHIPCO-PUMPS.COM

SHIPCO® IS A REGISTERED TRADEMARK OF SHIPPENSBURG PUMP CO., INC.

516 AWF-B Vertical & Horizontal 184, 213 & 215 TC Frame Three Phase Flexible Coupled

DRAWN BY S.A.D. DATE 10/08 REVISION .5

PARTS LIST # PL-81634

CUBE PART # AWF16B-5STG-S

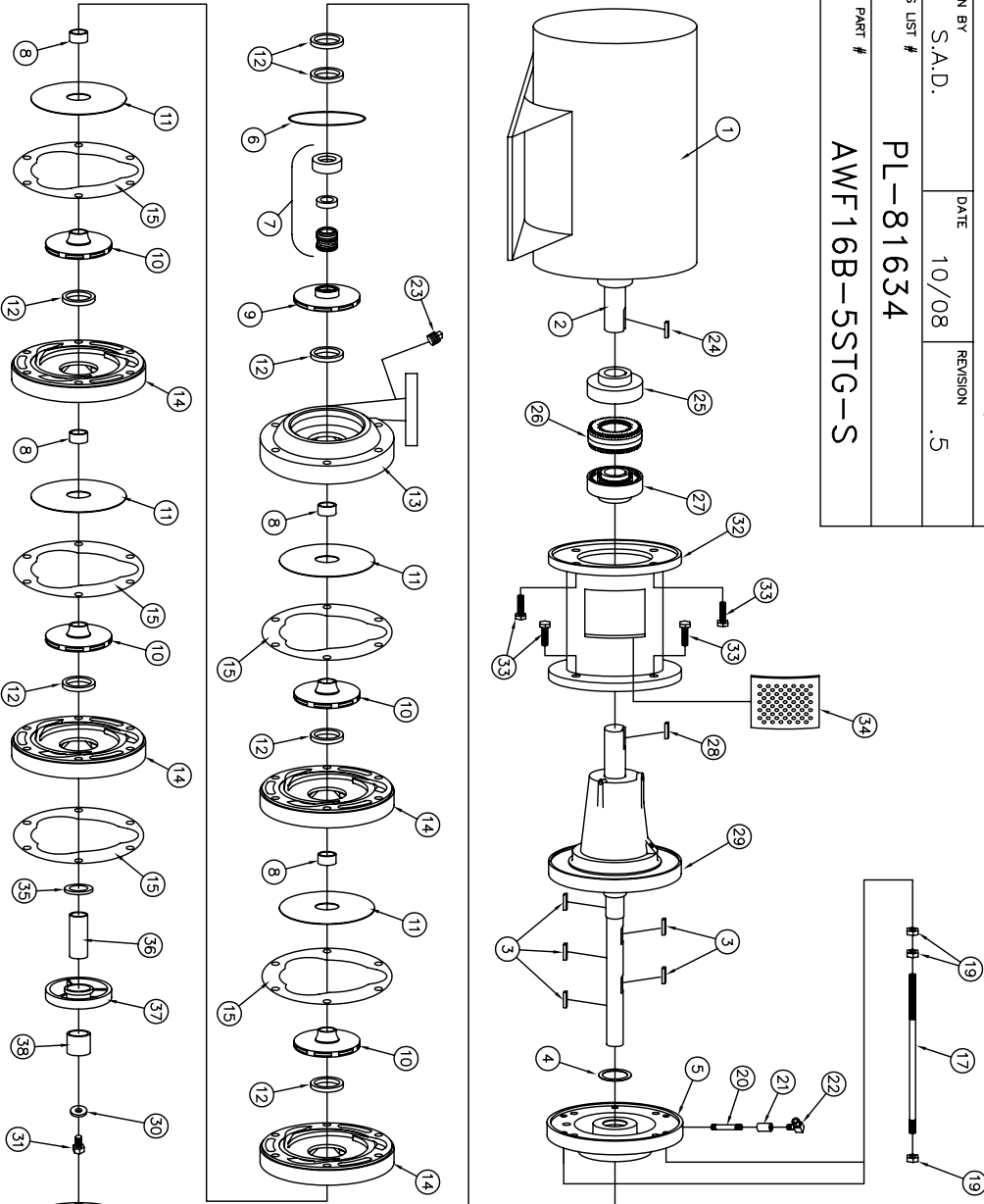

NO.	DESCRIPTION	PARTS LIST	PART NO.	QTY.
1	MOTOR / BEARING HOUSING	TC FRAME		1
2	MOTOR SHAFT	KEYBAR-S8-013-OVR		1
3	KEY (IMPELLER)	SLINGER-SDWS99996		5
4	WATER SLINGER	HEAD-SDPH00581		1
5	PUMP HEAD	ORING-SDP000674		1
6	HEAD GASKET (O-RING)	MCHSEAL-SDPS00155-SV		1
7	MECHANICAL SEAL 1 1/8"	SPACER-SDP500579		1
8	SPACER SLEEVE	IMP-SDP100042-1-4 7/8		4
9	IMPELLER (5th STAGE)	IMP-SDP100042-1-A-4 7/8		4
10	IMPELLER (1st thru 4th STAGE)	DIVPLT-SDPP000585		4
11	DIVIDER PLATE	WRGRING-SDPWR0032		7
12	WEARING RING	CASE-SDPC00577		1
13	PUMP VOLUTE CASE	PASSAGE-SDPP00576		4
14	PASSAGE	GASKET-SDPG03886		5
15	SUCTION HOUSING GASKET	SUCHSG-SDPH00747		1
16	SUCTION HOUSING (HORIZONTAL MOUNT)	SUCHSG-SDPH00747-A		1
17	SUCTION HOUSING (VERTICAL MOUNT)	CLAMPINGBOLT-SDPB000595-C		6
18	CLAMPING BOLT	FLG-ASA-SPT15-GKT-0300		1
19	SUCTION GASKET	FTRNUT-5HZ-0050C-2		18
20	HEX NUT (STAGE RETAINING NUT)	NIPPLE-B-0025,250		1
21	1/4" NIPPLE 1/4 x 1/2	CLP-FGB-0025		1
22	1/4" 90° COMPRESSION FITTING	CPMFTG-R-MELL-038-025		1
23	1/4" PIPE PLUG	PF-PLUGSQ-SLD-B-0025		1
24	KEY (MOTOR SIDE)	PER MOTOR ORDERED		1
25	WOODS COUPLING (MOTOR)	PER MOTOR ORDERED		1
26	SURE-FLEX SLEEVE	PER MOTOR ORDERED		1
27	WOODS COUPLING (PUMP SIDE)	PER MOTOR ORDERED		1
28	KEY (PUMP SIDE)	KEYBAR-S8-025-OVR		1
29	BEARING ASSEMBLY	BRHSG-SDPBH00687		1
30	IMPELLER WASHER	IMPWHR-SDPRW00671		1
31	IMPELLER CAPSCREW	FTRCOP-5HZ-0050C-0075-2		1
32	ADAPTOR ASSEMBLY	BRHSG-SDPH00587		1
33	MOUNTING BOLT	-		8
34	COUPLING GUARD SCREEN	BRHSG-GUARDSCREEN-S3333331		1
35	IMPELLER WASHER	IMPWHR-SDPRW00743		1
36	SHAFT SLEEVE	SHTSLVE-SDPC00742		1
37	IDLER BEARING HOUSING	BRHSG-SDPS00748		1
38	IDLER BEARING	BEARING-BALL-CUTLASS		1

