

# SHIPCO PUMPS

MANUFACTURED BY

SHIPPENSBURG PUMP COMPANY INC.

P.O. Box 279 Shippenburg, Pa. 17257

PHONE 717 532-7321 / FAX 717 532-7704

WWW.SHIPCO.PUMPS.COM

SHIPCO® IS A REGISTERED TRADEMARK OF SHIPPENSBURG PUMP CO., INC.

## 127 Model D Horiz End Suction 56J Frame Three Phase

DRAWN BY J.BROOKENS DATE 9/04 REVISION .3

PARTS LIST # PL-82705

QUEB PART # 127DH56J3

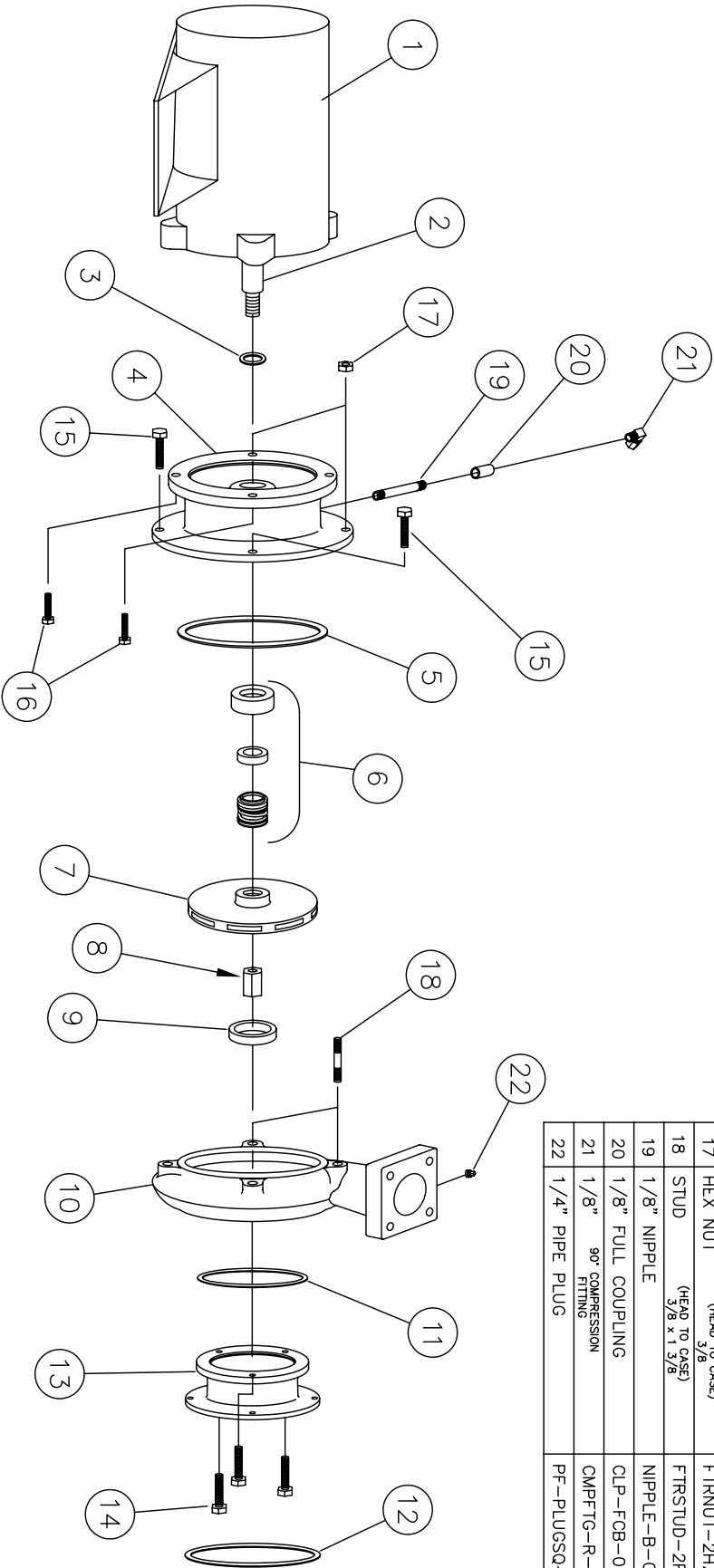

PARTS LIST			
NO.	DESCRIPTION	PART NO.	QTY.
1	MOTOR	56J FRAME	1
2	MOTOR SHAFT		1
3	WATER SLINGER	SLINGER-SDWS99999	1
4	PUMP HEAD	HEAD-SDPH00035	1
5	HEAD GASKET	GASKET-SDPG03826	1
6	MECHANICAL SEAL 5/8"	MCHSEAL-SDPS00067	1
7	IMPELLER	IMP-SDP100145-A	1
8	IMPELLER LOCK NUT	IMPNUIT-S3333234	1
9	WEARING RING	WRGRING-SDPWR0033	1
10	PUMP CASE	CASE-SDPC00047	1
11	SUCTION HOUSING GASKET	GASKET-SDPG03829	1
12	SUCTION HOUSING GASKET	FLG-ASA-SP15-GKT-0300	1
13	SUCTION HOUSING	SUCHSG-SDPF00050-B	1
14	CAPSCREWS (Suction Housing to Case)	FTRCP-5HZ-0038C-0125-2	3
15	CAPSCREWS (HEAD TO CASE)	FTRCP-5HZ-0038C-0100-2	2
16	CAPSCREWS (MOTOR TO HEAD)	FTRCP-5HZ-0038C-0075-2	4
17	HEX NUT (HEAD TO CASE)	FTRNUT-2HZ-0038C-2	2
18	STUD (HEAD TO CASE)	FTRSTUD-2P-0038C-0138-2	2
19	1/8" NIPPLE	NIPPLE-B-0013x250	1
20	1/8" FULL COUPLING	CLP-FCB-0013	1
21	1/8" 90° COMPRESSION FITTING	CMPFTG-R-MELL-025-013	1
22	1/4" PIPE PLUG	PF-PLUGSQ-SLD-B-0025	1