

SHIPCO® PUMPS

MANUFACTURED BY

SHIPPENSBURG PUMP COMPANY INC.

P.O. Box 279 Shippenburg, Pa. 17257
PHONE 717 532-7321 / FAX 717 532-7704

WWW.SHIPCO-PUMPS.COM

SHIPCO® IS A REGISTERED TRADEMARK OF SHIPPENSBURG PUMP CO., INC.

131 AWF Model Horizontal 284 & 286 TSC Frame Three Phase Flexible Coupled

DRAWN BY M.E.R. DATE 6/07 REVISION .4

PARTS LIST # PL-83122

CUBE PART # AWF31-1STG-L

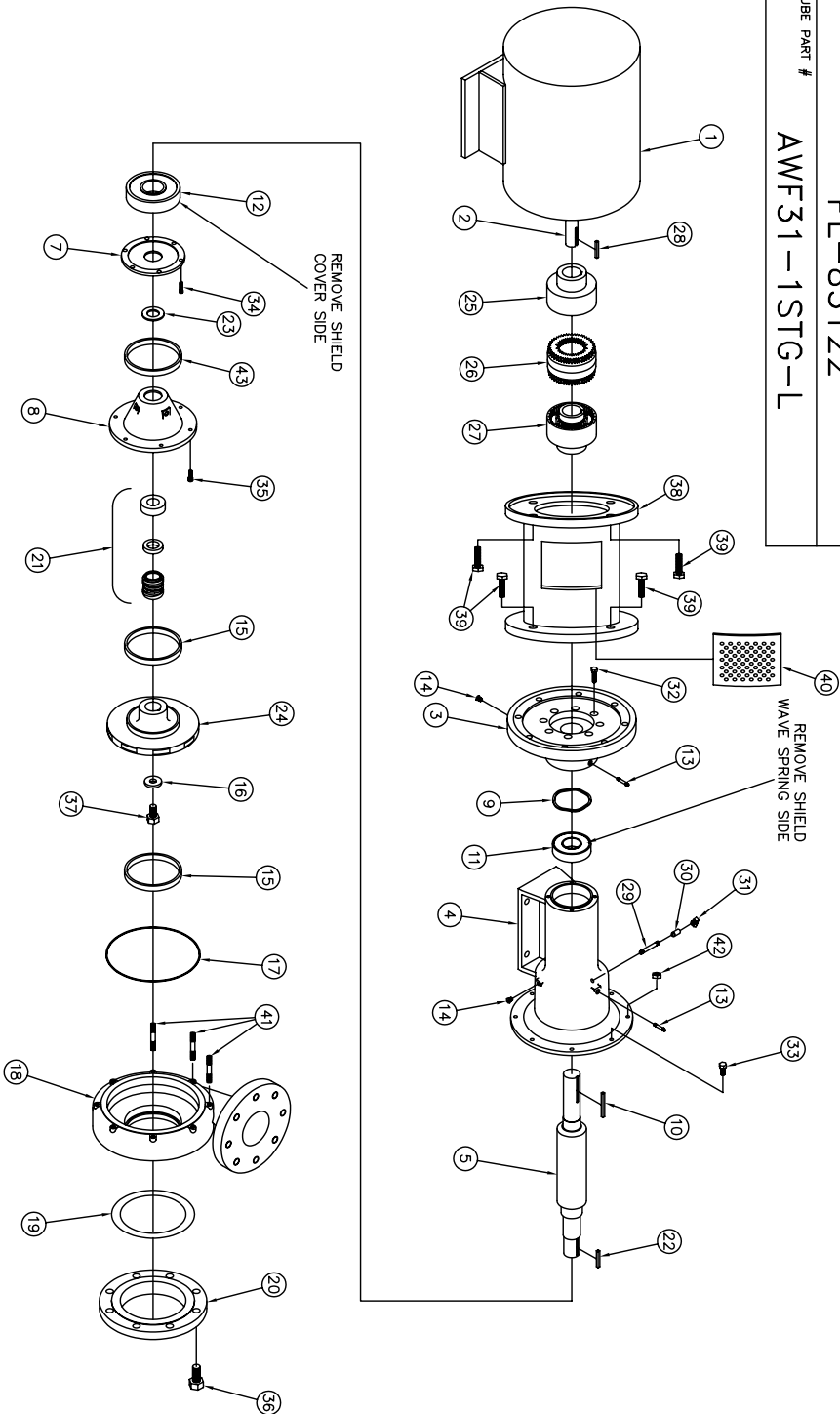

BEARING HOUSING ASSEMBLY SDPBH00695

PARTS LIST

NO.	DESCRIPTION	PART NO.	QTY.
1	MOTOR / BEARING HOUSING	TSC/AM FRAME	1
2	MOTOR SHAFT		1
3	COVER - IDLER BEARING	BRHSG-SDP00634	1
4	BEARING HOUSING	BRHSG-SDPBH00625	1
5	SHAFT - FLEX COUPLED	BRHSG-SDP500635	1
7	BEARING RETAINING COVER	BRHSG-SDP000626	1
8	SEAL CASING	BRHSG-SDP500627-A	1
9	WAVE SPRING	BRHSG-WAVSPRG-SSB-0394	1
10	KEY (PUMP SIDE) 3/8 x 3	KEYBAR-S8-038-OVR	1
11	BEARING	BRHSG-BRG-6309-2RS	1
12	BEARING	BRHSG-BRG-6314-ZZ	1
13	GREASE FITTING	GREASE-FTG ST	2
14	PRESSURE RELIEF VENT	GREASFT-RELIF-0013	2
15	WEARING RING	WRGRING-SDPWR00624	2
16	IMPELLER WASHER	IMPWHR-SDPRW00630	1
17	O-RING	ORING-SDP000083	1
18	VOLUTE CASE	CASE-SDPC00620	1
19	GASKET	FLG-ASA-SP15-GKT-0600	1
20	6" ASA FLANGE	FLG-ASA-SP15-0600	1
21	MECHANICAL SEAL 1 3/4"	MCHSEAL-SDP500698-SV	1
22	KEY (IMPELLER) 1/4 x 3/4	KEYBAR-S8-028-OVR	1
23	WATER SLINGER	SLNGFR-SDWS99997	1
24	IMPELLER	IMP-SDP000575	1
25	WOODS COUPLING (MOTOR)	FLEXCLP-95-0163-0038	1
26	SURE-FLEX SLEEVE	FLEXCLP-SLVE-9UMS	1
27	WOODS COUPLING (PUMP SIDE)	FLEXCLP-95-0163-0038	1
28	KEY (MOTOR SIDE) 3/8 x 2	KEYBAR-S8-050-OVR	1
29	1/4" NIPPLE 1/4 x 2 1/2	NIPPLE-B-0025x250	1
30	1/4" FULL COUPLING	CLP-FCB-0025	1
31	1/4" 90° COMPRESSION FITTING	CPMFTG-R-MELL-038-025	1
32	CAPSCREW (ROUSING TO VOUNT)	FTRCP-5KZ-0038C-0175-2	6
33	HEX SCREW (ROUSING TO VOUNT)	FTRCP-5HZ-0038C-0075-2	5
34	CAPSCREW (COUPLER TO HOUSING)	FTRCP-5KZ-0025C-0050-2	6
35	CAPSCREW (SEAL CASING TO HOUSING)	FTRCP-5KZ-0031C-0075-2	6
36	HEX SCREW (SHAFT TO VOUNT)	FTRCP-5HZ-0075C-0175-2	8
37	HEX SCREW (SHAFT)	FTRCP-5HZ-0050C-0075-2	1
38	COUPLING GUARD	BRHSG-SS333351	1
39	MOUNTING BOLT	FTRCP-5HZ-0050C-0125-2	12
40	COUPLING GUARD SCREEN	BRHSG-SS333355	1
41	STUD (ROUSING TO VOUNT)	FTRSTUD-2P-0038C-0138-2	3
42	HEX NUT (ROUSING TO VOUNT)	FTRNUT-5HZ-0038C-2	3
43	O-RING	ORING-SDP000728	1